



## APR450 Reader

### Quick Start Up Guide

The Allflex APR450 Reader is made to read livestock electronic identification Tags (EID) that offer simple-to-use essential reading and management capabilities and delivers outstanding value even for small farms.



# What is in the Box

ATB400 - Transport box

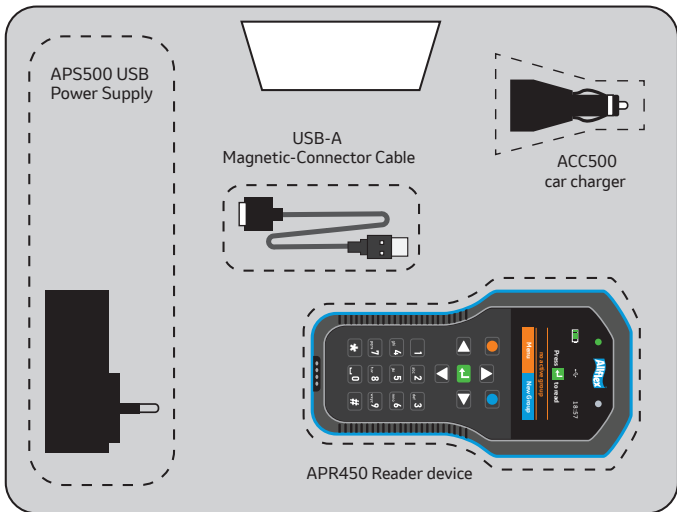

## Allflex CONNECT

**Introducing Allflex Connect - a universal mobile APP to connect your EID readers with an on-farm management platform, external identification systems, and the Allflex cloud.**

With Allflex Connect, you can create and edit customized animal cards and lists, share records with your herd management system, upload data to the cloud for actionable insights, connect your reader to your mobile via Bluetooth, and keep your readers up to date with regular firmware updates.

Downloading the App and pairing it with your reader before first use is recommended.

To download, please visit Google Play or the Apple Store.



# Getting Started

## Battery Charge

The device should be fully charged before the first use.

To charge, use the provided Magnetic-USB power source.

Connecting the USB cable:

The magnetized connectors “find” the proper orientation almost automatically by attracting each other in the appropriate order.

*Note: DO NOT FORCE a connection to the reader. If it does not insert smoothly, verify that it is correctly oriented.*

Charging is complete if no bars are flashing anymore



To disconnect, pull the connector away from the device

When fully charged, the battery info will show ‘100%,’ and you can see a rough estimation for operating time in Standby Mode and continuous Read Mode

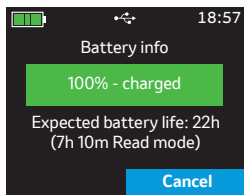
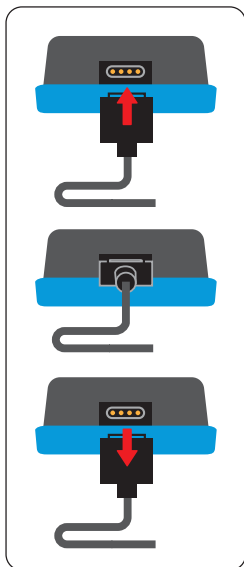

## Initial Configuration

### Set Language:

The default display language will be English at first start-up. You can change the language by accessing the menu, going to "setup," and choosing "set language." Navigating the options using the direction keys, you can then select your language preference by pressing ENTER.

### Set Read mode:

By default, the reader is set to ‘Single Read’ - one scan click per animal. Choosing the ‘Continuous mode’ enables batch reading.

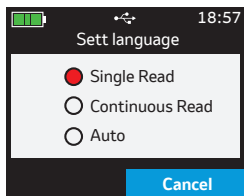
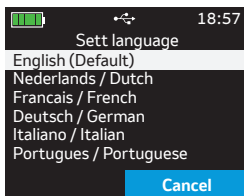

# Device Properties

## Multi-Color Status Led

The color changes according to the charging status when the display is switched off

- Flashing - Charging
- Solid - Fully Charged

## Blue Status Led

Used to indicate the connection status when the display is switched off

- Flashing every 3 seconds - SD Card Mode
- Flashing once a second - Suspend Mode (CDC)

## Port for external antenna



**A Large 2.4-inch Color Display**

## Easily Controlled Ergonomic Keypad

Directional pad with an ENTER key and two soft keys for multiple functions

12 Alphanumeric Keys for convenient data entry

**Magnetic UBS Connector**

## Display

### Battery Status Indicator

Shows the approximate battery level. It also displays battery faults, such as high temperature.

### USB connection

Indicates when the reader is connected via USB

### Clock

Clock time in 24-hour mode

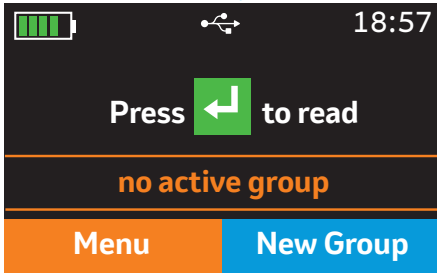

### Left Soft-Key

Performs various functions depending on the associated screen display

### Right Soft-Key

Performs various functions depending on the associated screen display

## Keypad

### Left Soft-Key

Power On/  
ENTER Key

### Right Soft-Key

### Direction Keys

For navigation,  
scrolling, and  
character selection  
in input fields

### Alphanumeric Keys for data entry

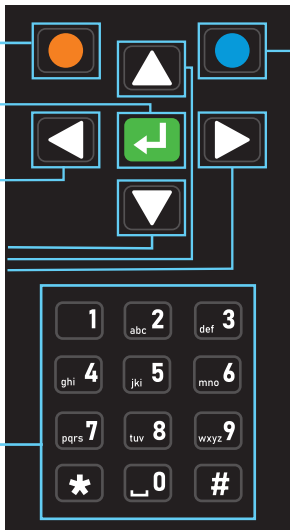

*NOTE: Press the down button key for >2 seconds to switch off the device*

# Quick Reading Steps

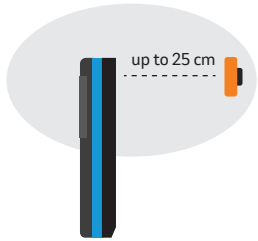

## Reading EID Tags:

1. Press ENTER to Read
2. Scan the EID tag near the field lines of the reader
3. The device's RGB LED signal will turn on, as well as the signalization motors (sound and vibration)



4. The tag will be shown on the display screen when successfully read

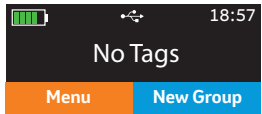

5. A 'No Tag' message will appear on the screen if the reading fails

## Assigning Tags:

1. At the home display, press the New Group button
2. Insert Group Name using the direction keys to navigate the letters, numbers, or symbols
3. When finished, press 'Close' to exit the keyboard, and confirm the name by pressing ENTER.
4. To assign tags to the group created, enter the group and start reading.

*NOTE: After 10.000 records within one group, the device will force the user to create a new group*

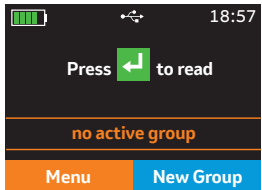

For more information visit  
[www.allflex.global/allflex-apr-450-product-support-page/](http://www.allflex.global/allflex-apr-450-product-support-page/)



This product is not intended to diagnose, treat, cure, or prevent any disease in animals. For the diagnosis, treatment, cure, or prevention of disease in animals, you should consult your veterinarian. The accuracy of the data collected and presented through this product is not intended to match that of medical devices or scientific measurement devices.

Copyright© 2023 Merck & Co., Inc., Rahway, NJ, USA and its affiliates.

All rights reserved. AHI-Allflex-231000008

